

ENGINEERING EXCELLENCE

AT IOWA STATE UNIVERSITY



IOWA STATE UNIVERSITY

Department of Civil, Construction and Environmental Engineering



Engineering Excellence at Iowa State University

Resilient buildings and bridges. Safer roads. Sustainable materials. Innovative construction. Clean drinking water. Intelligent infrastructure. Every aspect of the Iowa State University Department of Civil, Construction and Environmental Engineering is focused on a better quality of life for Iowa, our nation and our world.

Iowa State is renowned for excellence in engineering, with the College of Engineering consistently ranked among the top programs at public universities; within the college, the Department of Civil, Construction and Environmental Engineering has long contributed to this high standing. The department takes pride in providing a student-centered, real-world undergraduate and graduate education that prepares students to contribute, compete and lead when they enter the workforce. Research with which our students participate meets the challenges of today and impacts our lives today and tomorrow.

Offering undergraduate majors in three areas – civil, construction and environmental engineering – the department promotes an experiential, collaborative approach to learning.

From first-year Learning Communities through the integrated senior capstone courses, the curriculum is structured around a team-based educational model that includes practical application along with theory.

The department offers this high-quality education – and continues to garner high rankings – with limited facilities. The Town Engineering Building, located on the northwest corner of campus, has remained nearly unchanged for over 50 years since it was constructed in 1971, a time when classes were mainly presented in lecture format. This exciting project will be transformational for the CCEE department, providing much-needed community gathering and collaboration space, a prominent departmental presence and identity.

As educational models have evolved and other facility requirements have shifted over time, the need to expand and revitalize this building has become critical. A plan is underway that will help ensure an Iowa State civil, construction and environmental engineering education remains innovative and competitive for years to come.

POINTS OF PRIDE

100% placement rate

for construction engineers, civil engineers, and environmental engineers within six months of graduation.



ISU CIVIL ENGINEERING

graduate program

tied for

31st overall

in 2024 U.S. News and World Report rankings

undergraduate program

tied for

22nd overall

in 2022 U.S. News and World Report rankings

In Fall 2023, the program had:

> 500

undergraduate civil engineering students, making it the **4th largest program in the U.S.**

(American Society for Engineering Education, 2020)



233

undergraduate construction engineering students, making it the **largest program in the U.S.**

113

undergraduate environmental engineering students, only **three years** after the program started in 2020

Town Engineering: *Building for the Future*

The Department of Civil, Construction and Environmental Engineering's (CCEE) facility must reflect its collaborative, student-centered nature and meet the needs of today's and tomorrow's learning environment. The Town Engineering Building project consists of approximately 24,000 gross square feet of newly constructed and renovated space that will expand the building from 110,500 to 128,000 gross square feet – combining the construction of a two-story addition on the

south side of the building with the renovation of existing areas.

The plan features open, flexible instructional spaces and large collaboration areas that will allow students and faculty to engage in active learning and discussion. The overall design is meant to be inviting and inclusive, and will surround students in a dynamic living-learning environment and community.



Team-based teaching lab with Mechanical & Electrical Display Wall

CURRENT BUILDING



EXPANSION RENDERING



State-of-the-Art Collaboration and Instructional Spaces

The project will create a variety of bigger, brighter, student-centered spaces that will facilitate collaboration both within and beyond the classroom.

These new spaces will include:

- Large team-based instructional classroom
- Geodetics/surveying instructional lab for first-year engineering classes
- Environmental wet instructional laboratory
- Team-based instructional classroom emphasizing electrical and mechanical systems
- CCEE student advising center
- Open collaboration spaces
- Breakout/conference rooms
- Open-access computer collaboration area





Lobby and
Collaboration Space

New Entrance and Student-Centric Environment

A distinctive entryway – featuring open space and natural light – will establish a sense of identity that reflects the excellence of the department, inspiring pride in current students and greater appeal for prospective students. The CCEE student advising center will relocate to the first floor, allowing better access for prospective and current students and establishing a more prominent, welcoming and dynamic departmental presence in the building.



Living-Learning Laboratory

Throughout the new spaces, visible mechanical and structural components will create a living-learning environment where students can observe construction practices, study energy consumption by gathering building data from heating and cooling systems, and experience other hands-on learning.



The Time is Now

The time is right to embark on a vibrant vision for Town Engineering to ensure the future quality of a department that has long been a source of pride for its graduates. Pursuing this project today is vital to attracting quality students and preparing them to become the industry leaders for tomorrow. We look forward to working with alumni, friends and corporate partners on a project that promises to improve every aspect of Iowa State's civil, construction and environmental engineering education for generations to come.

To make this project a success, the department seeks \$33 million in private support from alumni, friends, corporations and other partners. The project will offer prominent naming opportunities for those who wish to have their names associated with the excellence of the department.

To learn more about how you can support the Town Engineering project, please contact:

Geleen Reed-Toresdahl

Director of Development

515-490-6885

greedtoresdahl@foundation.iastate.edu

www.ccee.iastate.edu/building-for-the-future-town-engineering-renovations

Images and plans are representational only and subject to change.



Images and plans are representational only and subject to change.

FIRST LEVEL

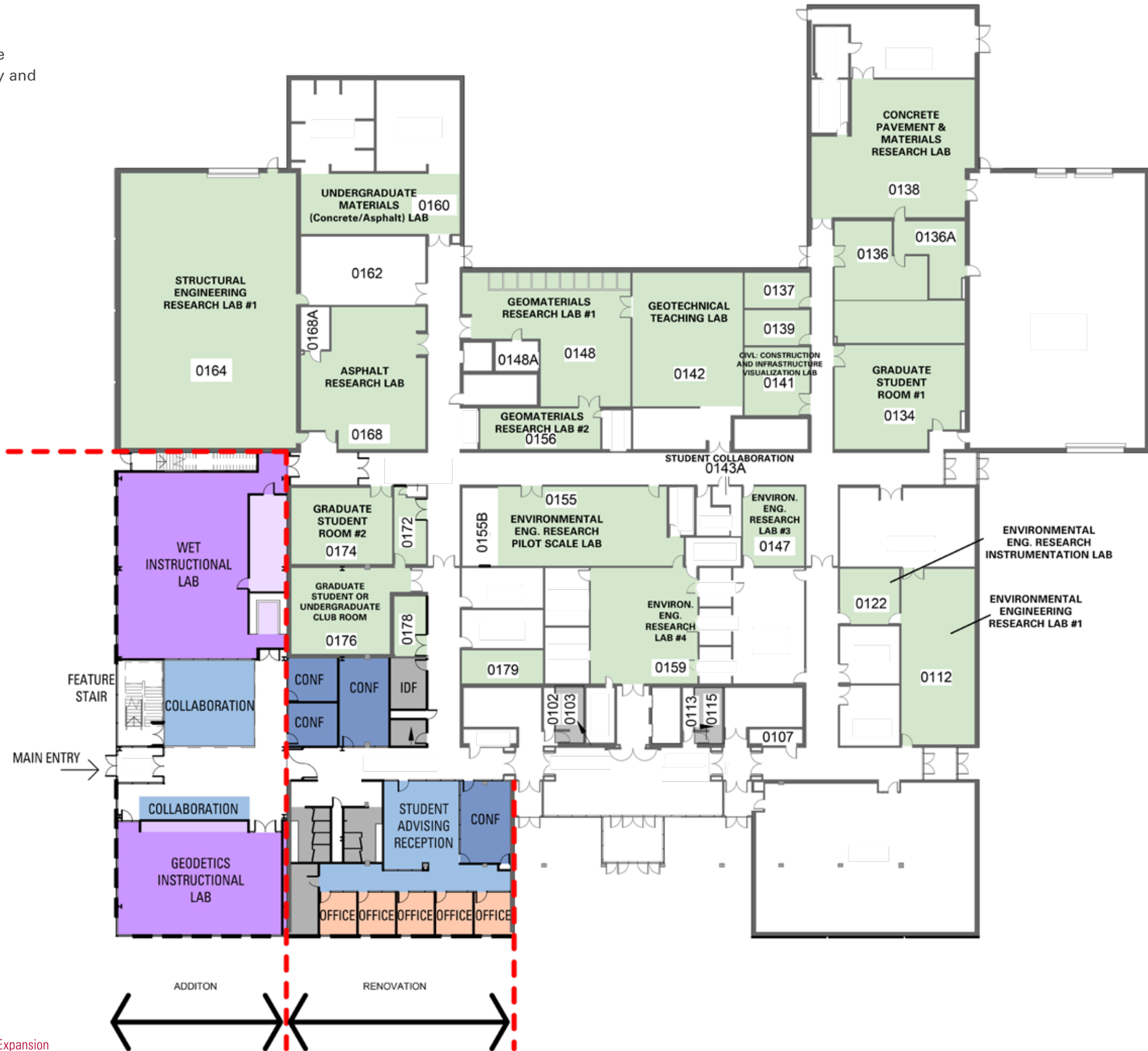

COLOR LEGEND

- Collaboration
- Conference
- Future CCEE Projects or Naming Opportunities
- Instructional Lab
- Office

Images and plans are representational only and subject to change.

SECOND LEVEL

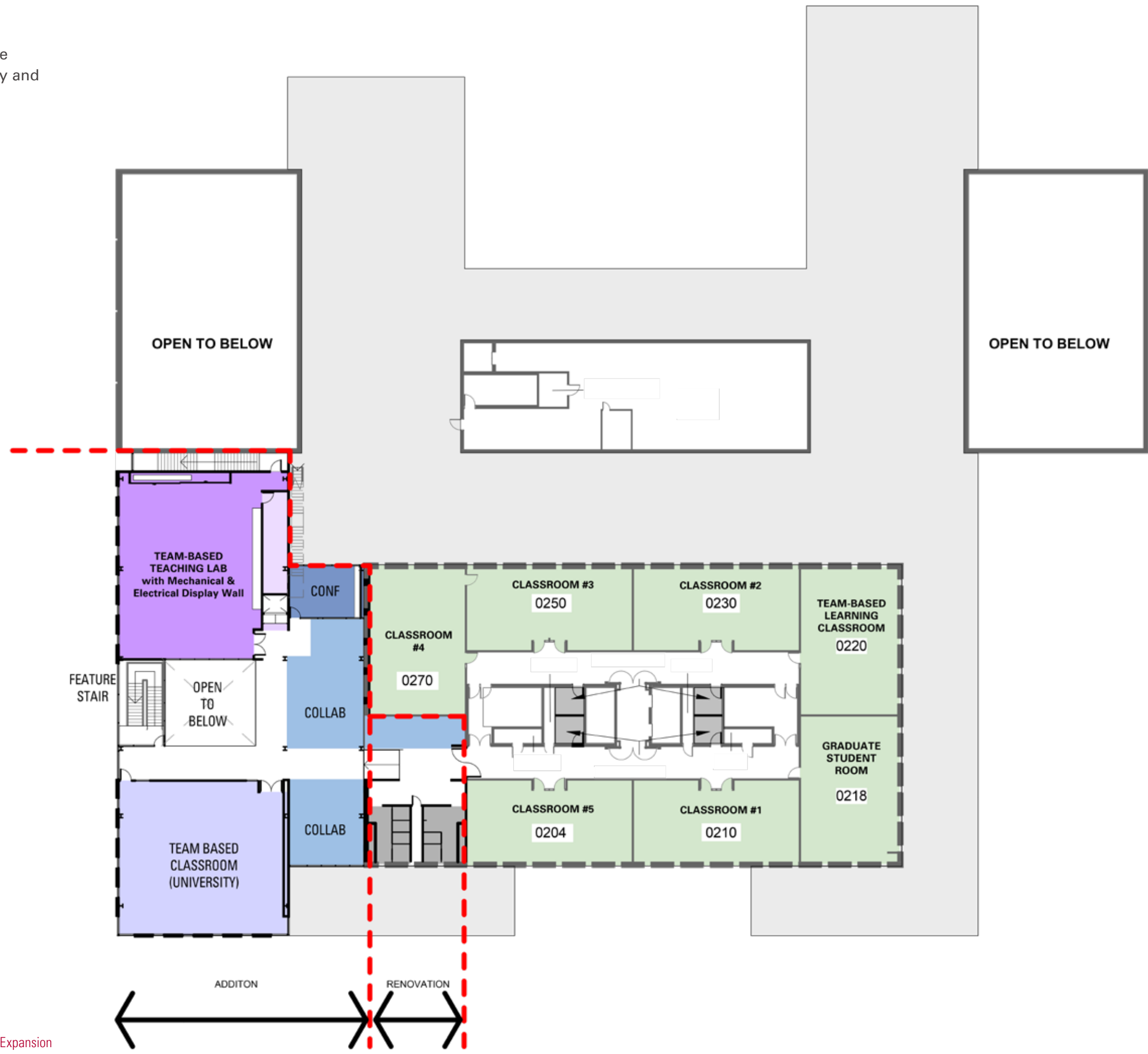

COLOR LEGEND

- Collaboration
- Conference
- Future CCEE Projects or Naming Opportunities
- Instructional Lab
- Classroom

Images and plans are representational only and subject to change.

THIRD LEVEL



COLOR LEGEND

■ Future CCEE Projects or Naming Opportunities

IOWA STATE
UNIVERSITY
FOUNDATION

2505 University Boulevard

P.O. Box 2230

Ames, Iowa 50010-2230

515.294.4607

www.foundation.iastate.edu